

Installation & Maintenance instructions for S-IRDS-LED-TOP.

Important Information

If you do not feel fully confident when dealing with electrical procedures, seek the advice of a qualified electrician. These products are designed for connection to DC 12V or 24V supply. Any damaged parts should be replaced as soon as possible. We will not accept responsibility for any claims arising from a poor installation.

Specification

Working Voltage	DC12V	DC24V
Maximum Load	24W	48W
Effective Range	<5cm	<5cm

Important User Advice

Always switch off mains supply before installation or cleaning.

Installation:

1. Switch off the mains power.
2. Choose between recessing or surface mounting the sensor.
3. For recessing the sensor cut a hole 14mm in diameter and feed the wire through the hole and push the sensor into place.
For surface mounting, screw the fixing bracket to the surface using two fixing screws. Then feed the wire through the hole and push the sensor into bracket.
Make sure that the sensor head is fitted within 5cm of the closing cupboard door.

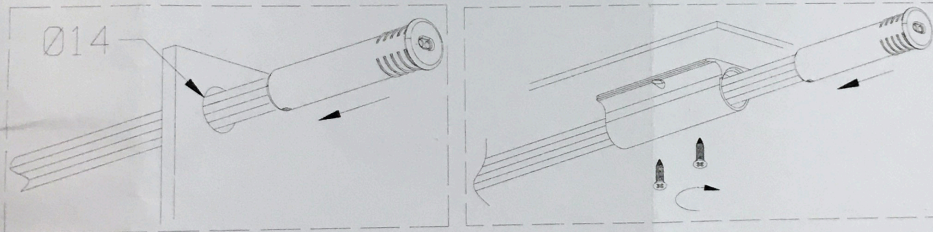

4. Connect the input into your DC driver and plug your light fittings into the output.

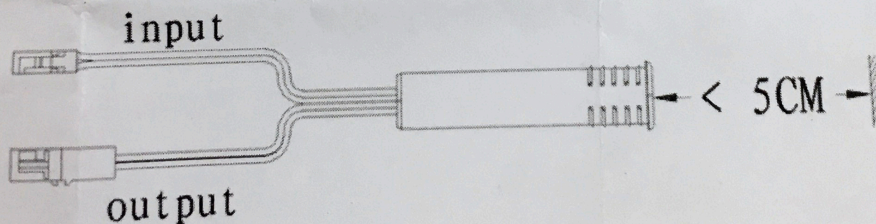

5. Turn the power back on.
6. When the cupboard door is closed and within the detection range the lights will be switched off. When there is no object in the detection range the lights will switch on.